



**CABLE
RAILING**

Enjoy the View



CABLE RAILING SYSTEMS

HORIZONTAL INFILL

VERTICAL INFILL

WWW.POLYVINYLC.COM

ABOUT KEY-LINK FENCING & RAILING

Key-Link is a leading manufacturer of quality aluminum fencing and railing for both residential and commercial projects. Key-Link is an affiliate company of Superior Plastic Products.



MODERN & CONTEMPORARY ALUMINUM

Thank you for your interest in Key-Link Fencing & Railing. Key-Link features many unique and appealing styles to choose from in today's most popular colors and textures. You'll see why Key-Link is the preferred choice for both Builders and Homeowners alike.



In addition to aluminum being lightweight and easy to work with, it's also very strong and durable; yet provides a very distinctive appearance to your setting. From securing your deck, porch or balcony to containment around your business, yard or pool, Key-Link is sure to have the solution perfect to meet your needs. Learn more about Key-Link and our products at KeyLinkOnline.com

POWDER COATING

Key-Link's AAMA 2604 & 2605 Powder Coated Aluminum Products Offers One Of The Most Economical, Longest-Lasting, & Color-Durable Quality Finishes On The Market Today.

- Economical, Durable & Long Lasting Decorative Finish
- Resistant to Chipping, Scratching, Fading & Wearing
- Increases Life of Product • Protects from Harsh Elements
- No Toxic Chemicals Released During Process
- Colors Stay Bright & Vibrant • Environmentally Friendly
- Reduced Energy Requirements • Uniformity Control



STANDARD AAMA 2604:

AAMA 2604 powder coatings are formulated with super durable or modified polyester resins. This finish provides good color and gloss retention for approximately five years of exposure.

OPTIONAL AAMA 2605:

AAMA 2605 is the high-performance exterior specification. These finishes are resistant to moisture, weathering, ozone and UV radiation. An application for this finish would include architectural projects that require long term cosmetic & functional protection up to ten years.

PRODUCT INDEX

	PAGE
Company Information	2
Powder Coating Overview	2
Vertical Cable Railing	4-5
Horizontal Cable Railing	6-7
Cable Fittings for Wood, Plastic & Composite Railing	8

NOW CHOOSE FROM TWO CABLE ALUMINUM RAIL SYSTEMS:

VERTICAL OR HORIZONTAL CABLE INFILL OPTIONS



VERTICAL CABLE SYSTEMS



AVAILABLE FOR AMERICAN RAILING

AMERICAN PROFILE

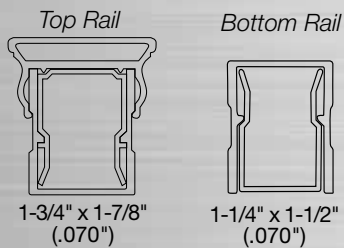

- Self-Centering Brackets
- Rattle-Free System
- Limited Lifetime Warranty
- AAMA Powder Coating
- 316 Grade S.S. Cable
- 36" & 42" Height Options
- 6' & 8' Length Options
- Performance Engineered & Tested to ICC Standards
- Perfect Solutions For Unobstructed Views

- No Jobsite Drilling Required for Typical Installations
- Sections Come Pre-assembled For Ease of Installation
- Boxed Kits Include Mounting Brackets & Hardware

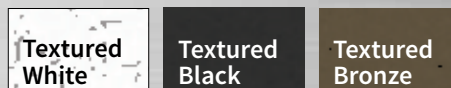

AMERICAN COLOR OPTIONS



HORIZONTAL CABLE SYSTEMS



CHOOSE BETWEEN TWO RAILING STYLES

AMERICAN PROFILE

Top Rail

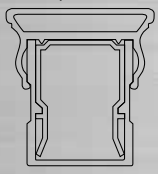

1-3/4" x 1-7/8"
(.070")

ARABIAN PROFILE

Top Rail

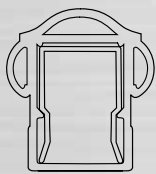

1-3/4" x 1-7/8"
(.070")

- Self-Centering Brackets
- Rattle-Free System
- Limited Lifetime Warranty
- AAMA Powder Coating
- 316 Grade S.S. Cable
- 36" & 42" Height Options
- 6' & 8' Length Options
- Performance Engineered & Tested to ICC Standards
- Perfect Solutions For Unobstructed Views

- Unique Pre-drilled Posts Make Installations Fast & Easy
- Cable Easily Rounds Corner Post Stairs w/One Tensioner Set
- Pre-drilled Center Baluster & Top Rail Conveniently Boxed as Kit
- Pre-installed Post Fittings Make Threading Cable Easy & Effortless
- Only Single Post at Corners • Cable Capable of Spanning up to 100'



ARABIAN COLOR OPTIONS

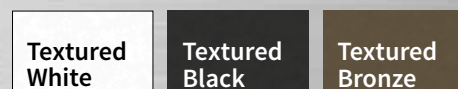

AMERICAN COLOR OPTIONS



CABLE RAIL FITTINGS STAINLESS STEEL HARDWARE

1 Sku - Level Rail • 1 Sku - Stair Rail

**LEVEL
FITTING**

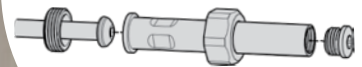

**STAIR
FITTING**

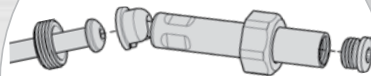

UPGRADE your new or existing wood, plastic or composite railing with stainless steel cable.

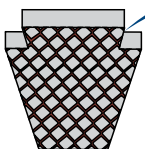

Key-Link
Fencing & Railing

VERS.KFRMK160919

DEALER

Item# DIACRCAT

